

Installation Guide

RGS, RGSR, RGSF, RGSK AND RGSbtb

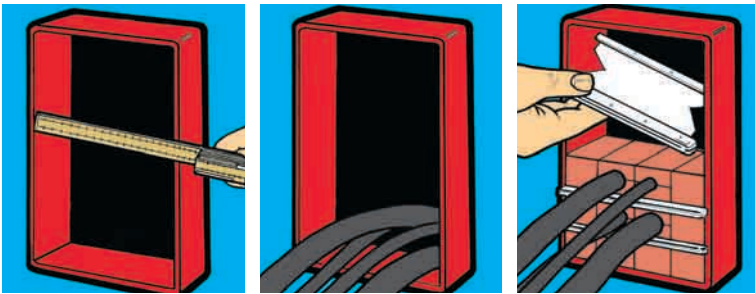

1 Measure the opening to ensure that its size conforms with tolerance standards 120,5 mm (± 0,5)

2 Make sure the frame is clean and lubricate the inside of the frame. Then pull cables through, placing the largest at the bottom.

3 Begin packing. A stayplate is inserted between each layer of insert blocks.

PRESSURE APPLICATIONS RGS, RGSC, RGSF, RGSK, RGSR AND RGSbtb

Make sure the frame is clean and lubricate the inside of the frame thoroughly. Lubricate all Lycron parts carefully with the MCT Brattberg lubricant.

Place the compression plate in the centre so that the rubber can come up between the compression plate and the frame on both sides of the plate.

The seal may not be pressurized within 48 hours of installation. This allows for the settlement of the system (based on a 20°C ambient temperature). NOTE. The lower the temperature, the longer the needed settlement time.

Certified pressure 2 bar (29.4 psi), test pressure 5 bar.

NOTE. For pressurized applications, all components must be replaced with new material after removal and refitting.

STG ENDPACKING

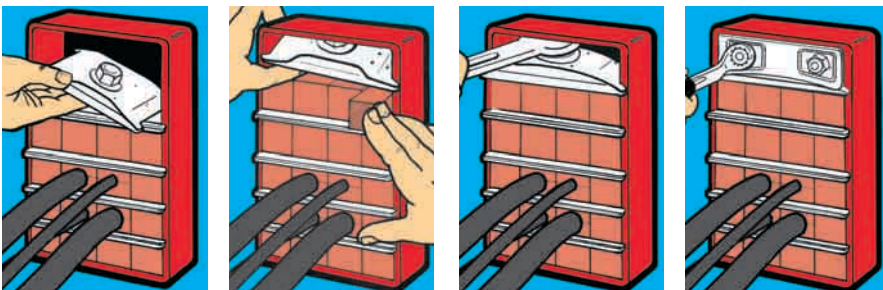

4 Insert the compression plate in the frame before the last row of blocks.

5-6 Insert the last row of blocks. Tighten the bolt until there is 32 mm between the top of the plate and the inside of the frame.

7 Insert endpacking STG with the tongue around the compression bolt. Tighten the nuts on the endpacking to compress and complete the seal. Approximately 12 mm of thread should protrude on each bolt.

RGSC

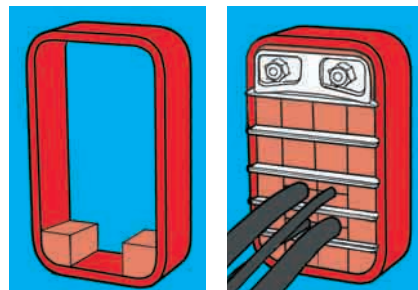

Begin packing with the special corner blocks. Insert endpacking STG with the tongue around the compression bolt. Tighten the nuts on the endpacking to compress and complete the seal. Approximately 12 mm of thread should protrude on each bolt.

PTG PRESSWEDGE

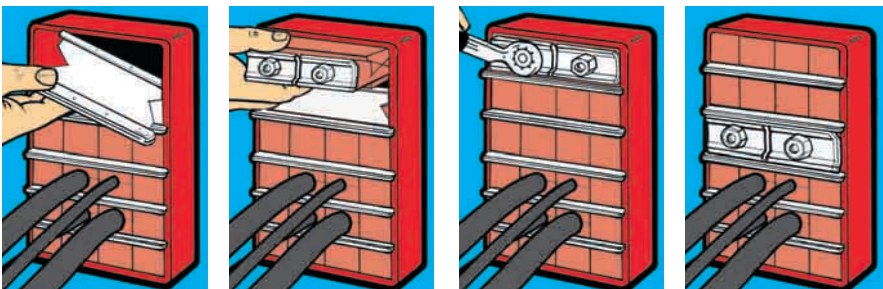

4 Insert the last two stayplates in the frame before the last row of blocks.

5 Fit first the PTG Presswedge at top of the frame. Insert then the last row of blocks.

6 Tighten the nuts until about 12 mm of thread protrudes on each bolt.

7 The PTG Presswedge can also be placed like this.

RGSC

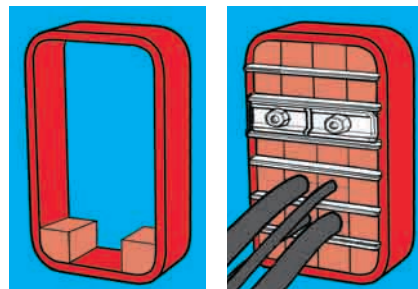

Begin packing using the special corner blocks. Place the PTG Presswedge anywhere, except at the top or bottom.

AddBlock

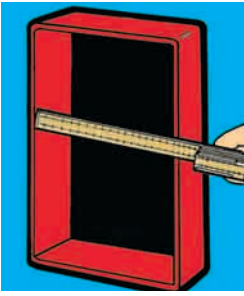

Measure the opening to ensure that its size conforms with tolerance standards $120,5 \text{ mm } (\pm 0,5)$.



Select a suitable block for the largest cable in the row.



Tear off attached sheet to fit the dimension selected.



Place sheet into centre slot and affix it with the unique locking device.

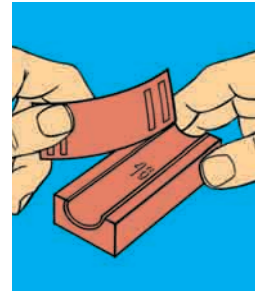

Tear off superfluous sheets.

U-Block

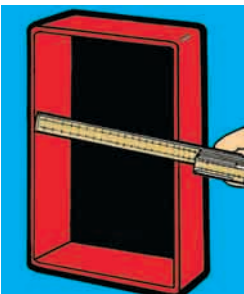

Measure the opening to ensure that its size conforms with tolerance standards $120,5 \text{ mm } (\pm 0,5)$.

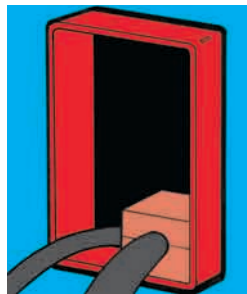

Select a suitable block for the largest cable in the row.

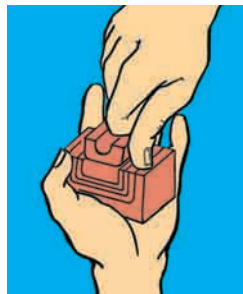

Select a suitable standard Block or AddBlock for the small cable. Then create a base using U-Blocks. The external measurements should be the same as the previous block.

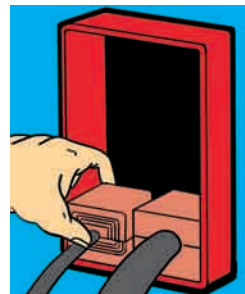

Start packing the frame.



Insert stayplates between each row of insert blocks.

Plug

PREPARING FOR A FUTURE INSTALLATION.



Choose an AddBlock suitable for the cable diameter.

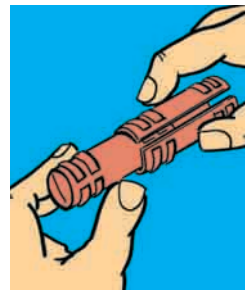

The centre plug is a snug fit for any pre-selected AddBlock since its diameter is adjustable - all thanks to the wraparound casing.



Place the plug in the AddBlock and make sure the locking devices secure it in place.